



GROUND FLOOR RETAIL/OFFICE SPACE

31-8650 Cinnamon Drive, Burnaby
1,082 sqft

For more information, please contact:

Bobbi Crandall 778.773.5157

REALTOR®

E cbobbi@telus.net

W tullisrealty.com

Executive Summary

LOCATION

Nestled in the Mountainside Village Shops in the Forest Hills area of North Burnaby, this retail strata unit is in a village of commercial and residential properties. Other tenants include convenience store, pizza parlor, childcare centre, accountant and more.

OPPORTUNITY

The premises is 1,082 sq ft previously occupied by a professional office with open floor plan, two private rooms and kitchenette area. The unit has extensive upgrades to the data capabilities and has been freshly painted.

Base Rate	\$23.00 psf per annum
Op Cost Rate	\$9.50 psf per annum
TOTAL RENT	\$2,930.42 + GST per month

ZONING C1, CD - Ask agent for further details

AVAILABLE IMMEDIATELY

For more information, please contact:

Bobbi Crandall 778.773.5157

REALTOR®

E cbobbi@telus.net

W tullisrealty.com

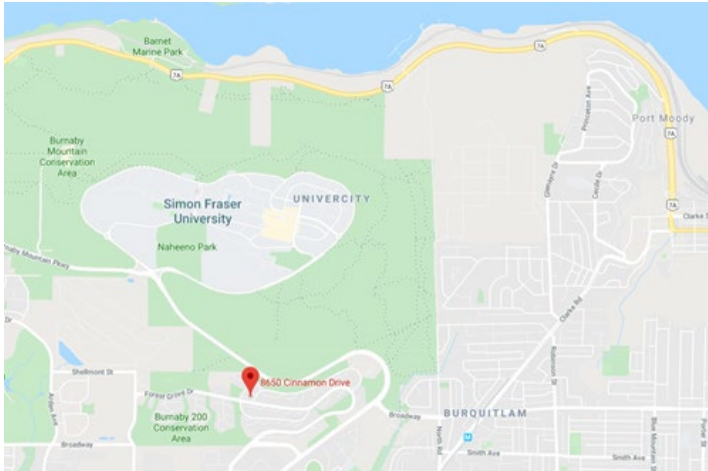

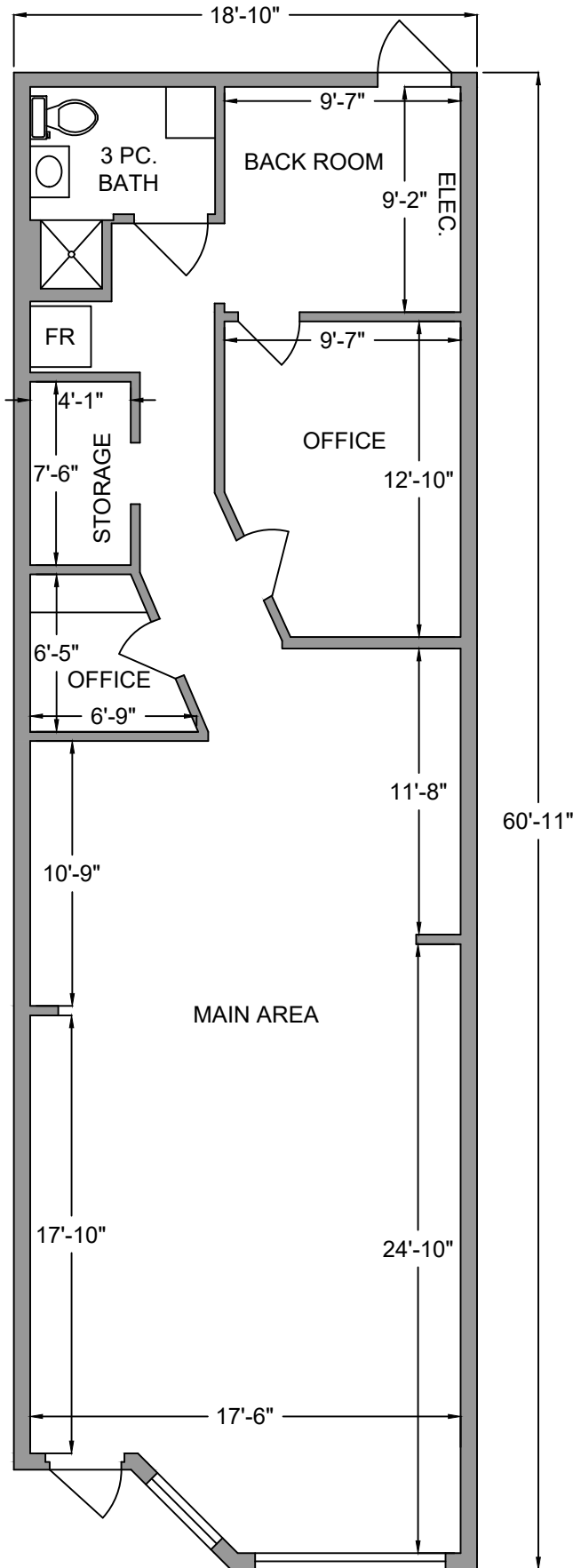

31-8650 CINNAMON DRIVE,
BURNABY
1082 SQ. FT.
8'5" - 6'10" CEILING

NORTH

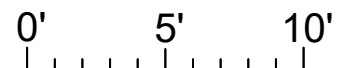
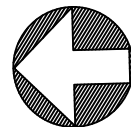

SCALE

31-8650 CINNAMON DRIVE, BURNABY
JULY 24, 2020

PREPARED BY PROPER MEASURE FOR THE EXCLUSIVE USE OF BOBBI CRANDELL.
PLANS MAY NOT BE 100% ACCURATE, IF CRITICAL BUYER TO VERIFY.
DIMENSIONS AND MEASUREMENTS ARE APPROXIMATE. THE FLOOR PLAN IS NOT INTENDED FOR ARCHITECTURAL OR CONSTRUCTION USE.
SQ.FT. CALCULATED TO CENTERLINE OF DEMISING WALLS AND TO THE FACE OF EXTERIOR WALLS.

FLOOR	AREA (SQ. FT.)
	FINISHED
MAIN	1082