

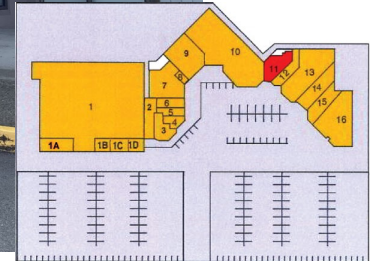

# RETAIL FOR LEASE



## Improved Ground Floor Retail Unit for Lease

**Unit 11 - 11924 207th Street  
Maple Ridge, BC**

For more information, please contact

**Bobbi Crandall** PREC\* 778.773.5157

REALTOR®

E [cbobbi@telus.net](mailto:cbobbi@telus.net)

W [tullisrealty.com](http://tullisrealty.com)



This communication is not intended to cause or induce breach of an existing agency agreement. Although this information has been received from sources deemed reliable, we assume no responsibility for its accuracy and without offering advice, make this submission to prior sale or lease, change in price or terms, and withdrawal without notice.

# FOR LEASE

## AVAILABILITY

1,356 retail space in a Meadow Ridge Shopping Centre. Boasting a highly central location with ample parking, and just off of the major transit corridor of Lougheed Highway in Maple Ridge, BC.

## LOCATION

The subject property is located on the north side of the Lougheed Highway and 207th Street intersection in Maple Ridge. Only a 5 minute drive from downtown Maple Ridge to the East, close proximity to the Golden Ears Bridge, and 15 minute drive to Coquitlam and Langley. Maple Ridge has been one of the fastest growing municipalities in the GVRD.

## THE PROPERTY

The Subject property is anchored by major tenants including Dulux Paint, Dollar Tree, Donair Top, and Value Village and is in close proximity to Westgate Shopping Centre and other prominent retailers. The building provides great signage opportunities and plenty of available parking.

## RENT

Base Rent \$28.00 psf

Additional Rent \$14.38 psf

Monthly Rent **\$5,138.58**

## ZONING

C-2 Community Commercial A wide range of retail and service commercial

## AVAILABILITY

Unit 11 1,455 sqft

11-11924 207TH STREET, MAPLE RIDGE

1454.65 SQ. FT.

10'0" CEILING

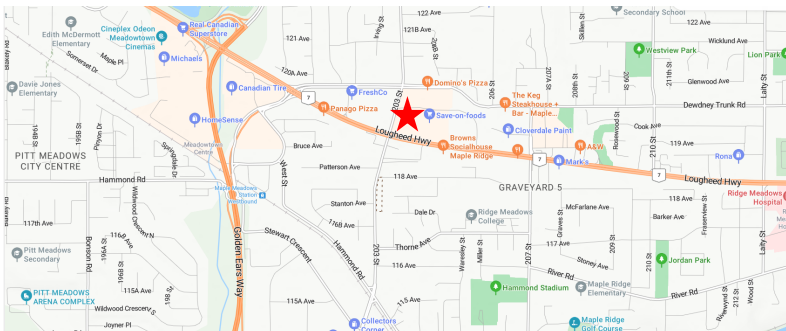
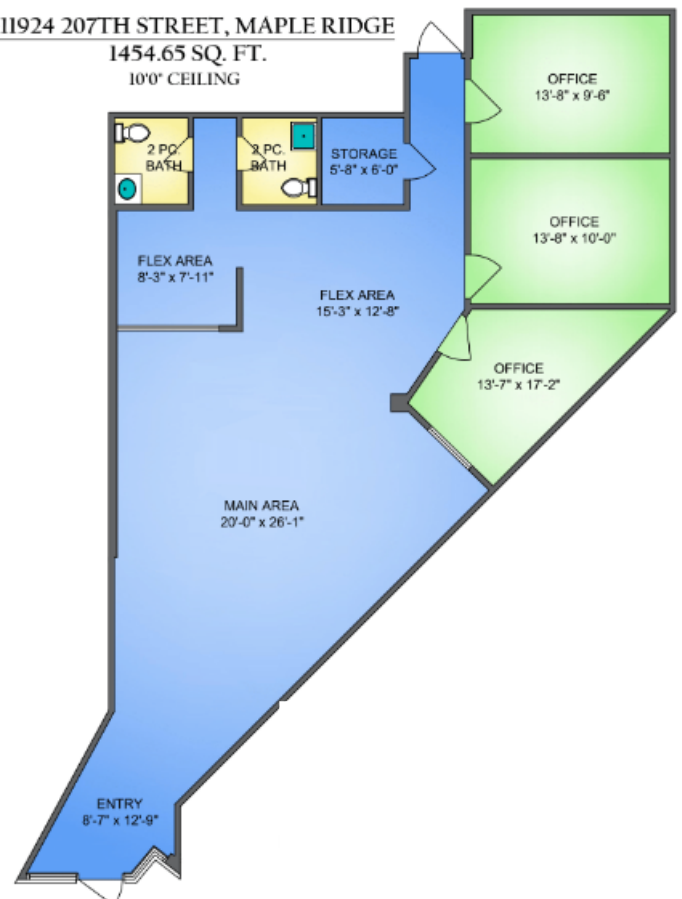

Bobbi Crandall PREC\* 778.773.5157

REALTOR®

E cbobbi@telus.net

W tullisrealty.com



E & O.E: This communication is not intended to cause or induce breach of an existing agency agreement. Although this information has been received from sources deemed reliable, we assume no responsibility for its accuracy and without offering advice, make this submission to prior sale or lease, change in price or terms, and withdrawal without notice.